

# QUICKGUIDE

## LUNA CEILING HOIST

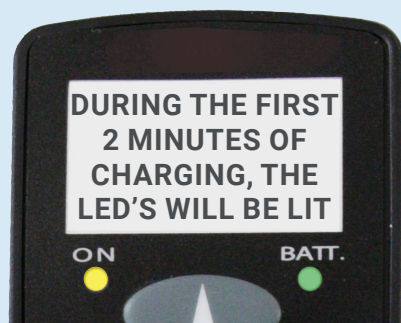

**REMEMBER  
ALWAYS TO PLACE  
THE HAND CONTROL  
IN THE CHARGER  
AFTER USE**



### Battery

- 100%
- 50 %.
- **MUST BE CHARGED**

### Lift up

### Lift down

### Reset

If the RESET button flashes: Press RESET down for 5 seconds, and the lift works again.

### Emergency stop

After pressing the red **STOP** button, **Reset** must be pressed down for 5 seconds, in order to re-activate the handcontrol.



### EMERGENCY LOWERING

Use if **Lift up / Lift down** isn't working; Press down the **parachute button** during lowering, which will start after 5 seconds. You will hear a constant "beep" when pressing down the parachute button.

If the electrical powered emergency lowering is not working, use the manual emergency lowering:

- ① Take the key from the top of the charger.
- ② Remove the hand control.
- ③ Remove the plug on the side of the Luna.
- ④ Put the key into the Luna.
- ⑤ Turn the key counter clockwise to lower the user.

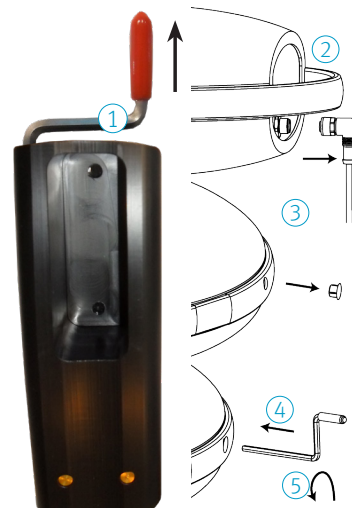

The hand control must always be connected in order for the lift to function.



Scan the QR-code for further information

